



Campaign Update #22:

Choice Financial announces partnership and donation to Light of Christ Catholic Schools



Choice Financial has partnered with Light of Christ Catholic Schools to build the first financial education center at a North Dakota high school. **Their donation of \$2 million will build the Choice Financial Business Center at the site of the new St. Mary's Central High School in north Bismarck, which is set to break ground in fall 2017.** To date, \$23.1 million has been raised in the campaign.

Light of Christ Catholic Schools has one of the state's most active Future Business Leaders of America chapters in the state with 50 members. The new center will serve as the home for all of the business-centered academics and related activities at the school, and a financial literacy program for all Light of Christ students, grades K-12.

"Our shared core values of putting people first and bettering the places we live and serve is what brings us together today for this partnership," stated Brian L. Johnson, CEO of Choice Financial. "We look forward to helping provide students and families a world-class learning environment in the Choice Financial Business Center, and the opportunity to provide tuition assistance for families."

The center will also serve as the home for a strong entrepreneurial education focus at the school. Students will be operating a food truck at local events, learning and managing all aspects of the business. The food truck was donated to the school as well.

"One focus with Light of Christ Catholic Schools is to help our students carry their knowledge and faith beyond the classroom walls," stated Gerald Vetter, President of Light of Christ Catholic Schools. "The overwhelming support we are receiving for this effort is an answer to a great deal of prayer and will serve as a blessing to our students, families and community for years to come."

Light of Christ Catholic Schools unveiled plans for the largest expansion project in its 138 years of existence in November 2015. Dr. Ron and Ruth Knutson and their family donated nearly 48 acres of land, located just north of 57th Street and east

of Washington Street in Bismarck, to provide a new home for St. Mary's Central High School.

In addition to plans for building a new school, the current high school/middle school on Second Street will be converted to a full middle school academy housing grades 6-8. Upgrades have been made, and will continue to be made to the current schools serving pre-school and elementary grade students.

The rapidly growing interest in Catholic education has spurred the need for expansion. Light of Christ Catholic Schools has experienced a 25 percent increase in students in the past five years, with seven percent growth in the 2016-17 school year.

Choice Financial, with 21 locations throughout the state, is a people first financial services organization that remains locally owned and built around long-term customer relationships and authentic community banking.

For more on Choice Financial's history, visit choicefinancialgroup.com/virtual-timeline.



Light of Christ Catholic Schools



CHOICE FINANCIAL
BUSINESS CENTER



SECOND FLOOR

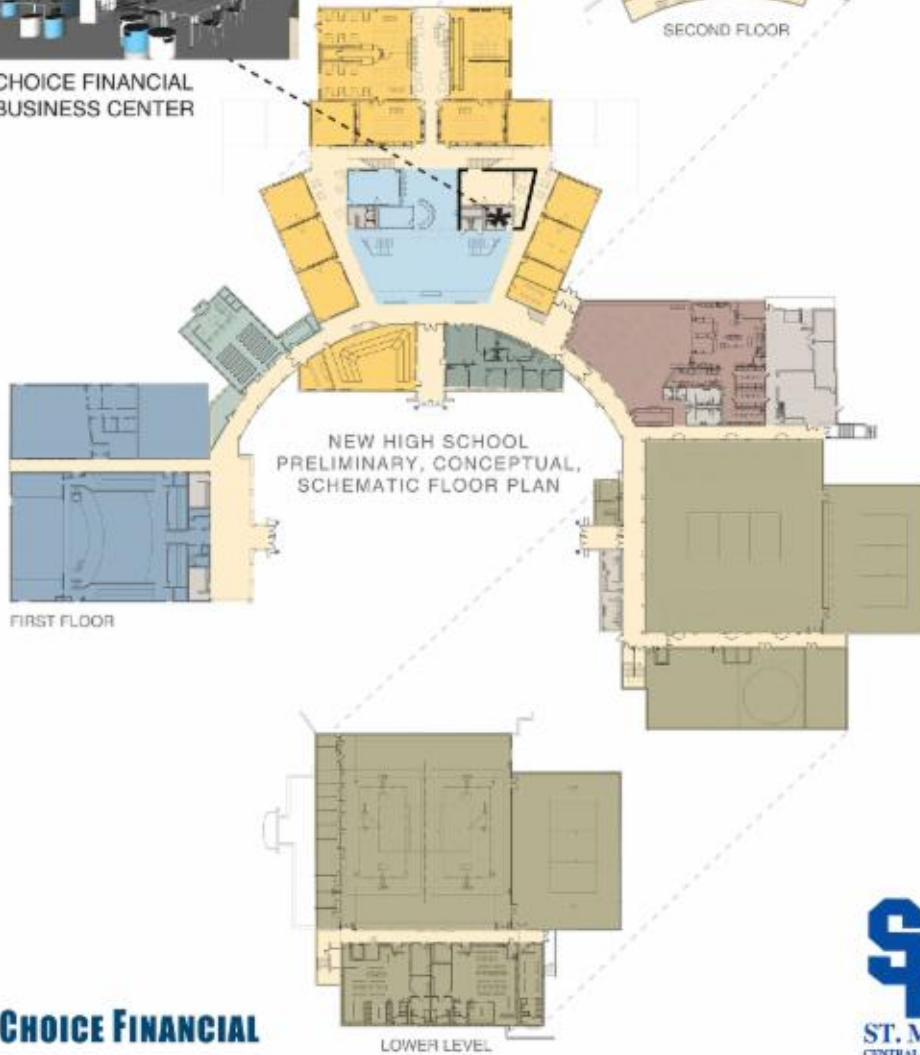

FIRST FLOOR

LOWER LEVEL



Have a question? Want to volunteer to help with the campaign?
Just use this simple form.

[CLICK HERE TO SUBMIT A QUESTION
OR VOLUNTEER TO HELP WITH THE CAMPAIGN.](#)

We invite you to share these updates with your friends and family and submit the names of friends/family that would like to receive these updates directly.
